

Connecting EIA-485 Communications Cables

Applicable Control Units: PSB3-30024

The EIA-485 Communications Cables can be used to connect up to four Control Units on the same signal line and distinguish between them through the settings on ID switches. The Cable models and the number of Cables that are required depend on the number of Control Units that are connected. Confirm the following information before you connect the Cables. Refer to the Optional Products for items labeled ① to ⑤.

Connecting One Control Unit

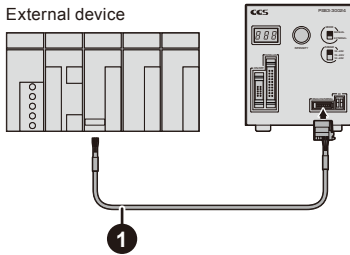

No.	Qty.
①	1
②	-
③	-
④	-
⑤	-

Optional Products

① EXCB2-E6SR-3

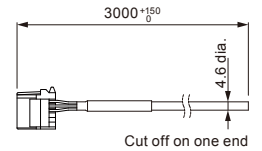

Connecting Two Control Units

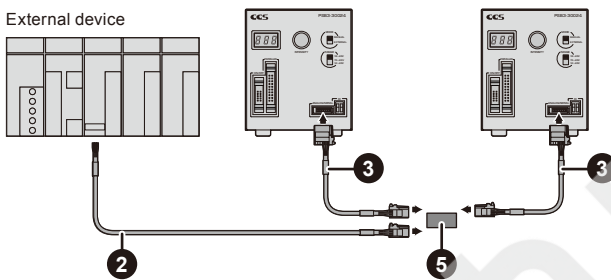

No.	Qty.
①	-
②	1
③	2
④	-
⑤	1

② EXCB2-E3-3

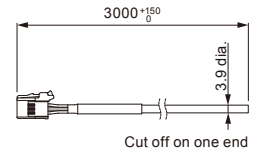

Connecting Three Control Units

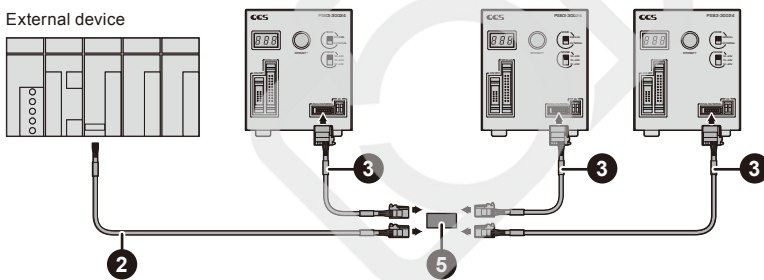

No.	Qty.
①	-
②	1
③	3
④	-
⑤	1

③ EXCB2-E6SR-E3-3

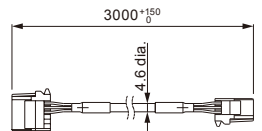

Connecting Four Control Units

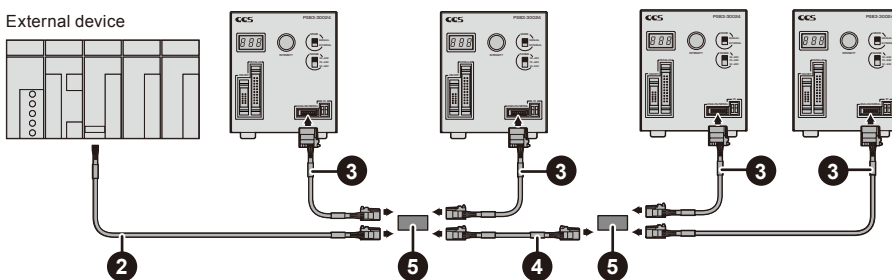

No.	Qty.
①	-
②	1
③	4
④	1
⑤	2

④ EXCB2-E3-E3-0.2

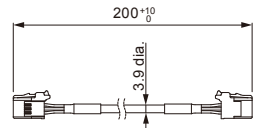

⑤ ECNR-E3CN4

