

LFV-PF-50RD

ELP-04NV_Connector 4P

Model name	LFV-PF-50RD
LED color	Red
Input voltage	48 VDC max.
Peak current	18 A max.
Weight	400 g max.
Connector	ELP-04NV
Polarity and signal	1: (+), 2: (+), 3: (-), 4: (-)

Unit: mm

4 x M4
(For installation)

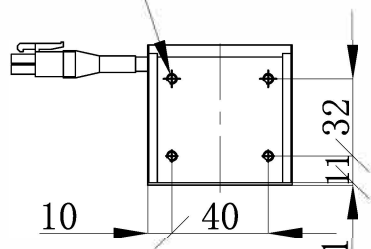

Emitting surface 52mm x 52mm

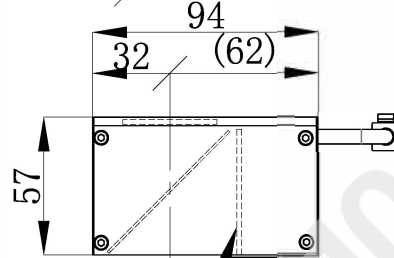
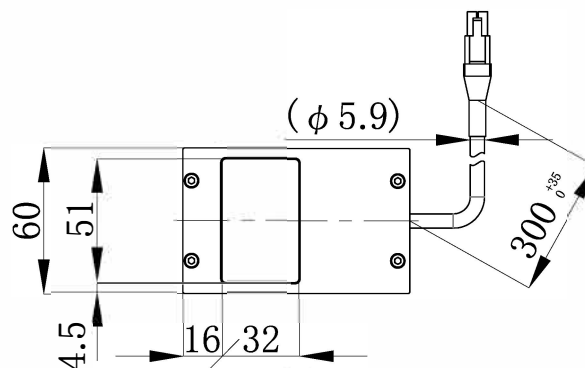

4 x M4
(For installation)

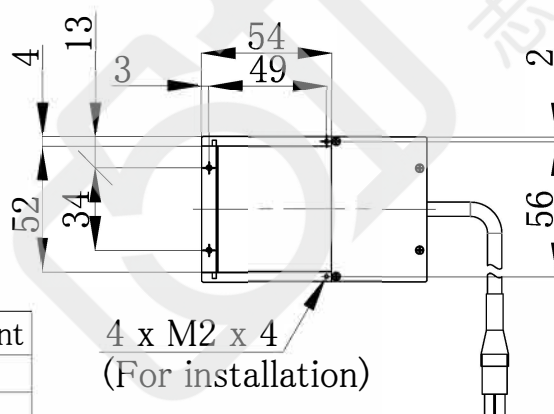
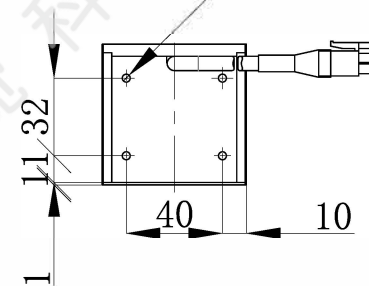

Model	Peak current
LFV-PF-50SW	21.6A
LFV-PF-50RD	18A

Do not light up the illuminator continuously.

This illuminator has some restrictions for light-up condition.

Please keep strictly the duty cycle under 1% and pulse width under 500 μ s.